

Behavioral Health

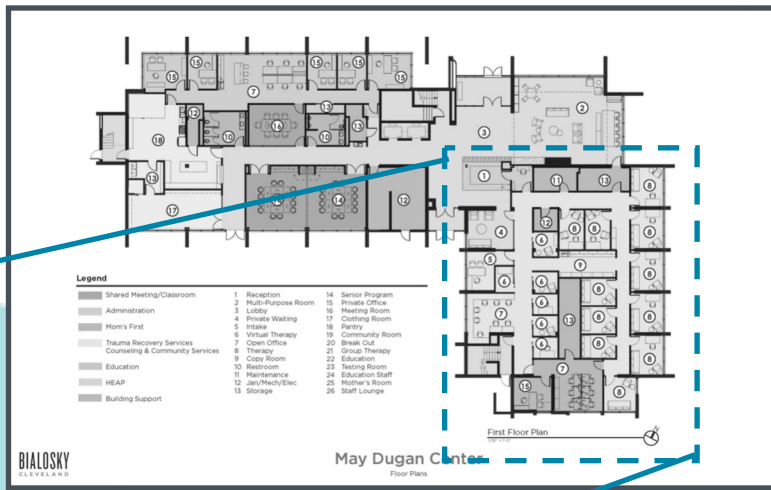

Upon completion of construction, the Behavioral Health Department will expand from 11 to 17 offices and will add two dedicated group therapy rooms.

Impact: Improved capacity to serve up to 225 more people who need mental health counseling, addiction treatment, and case management.

- Key:
- 5-Intake Office
 - 6-Virtual Therapy Offices.
 - 8-In-Person Therapy Rooms